

Canopies are supplied without any roof coverings so that the client can choose their own finish.

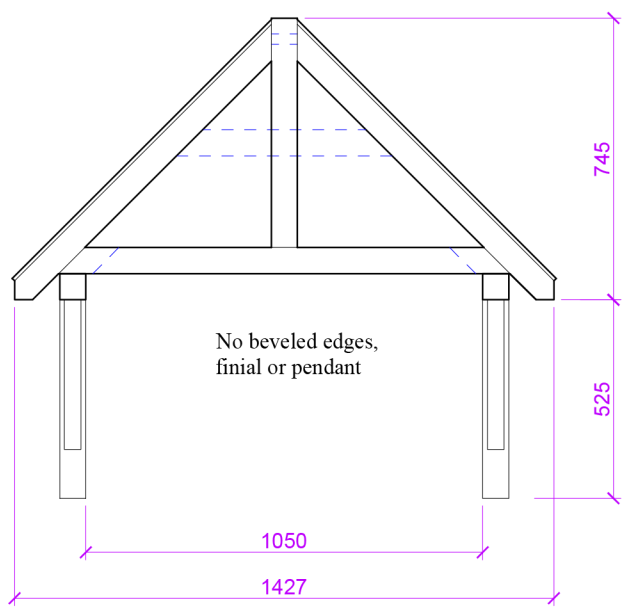

FRONT

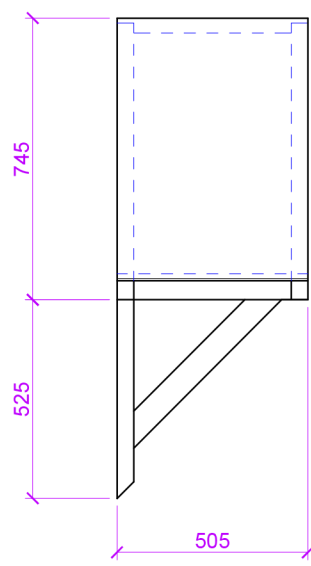

SIDE

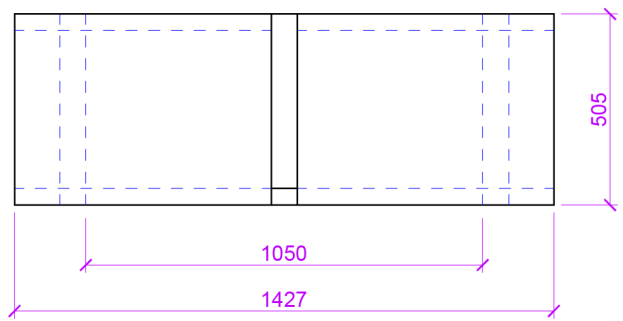

PLAN



ISOMETRIC

Timber Door Canopies
by George Woods

Unit A, The Old Ambrosia Works, Lapford, Devon, EX17 6AE
t: 01363 884218
email: sales@timberdoorcanopies.co.uk

www.timberdoorcanopies.co.uk

The standard Harcombe dimensions are: 1050mm between gallows x 745mm height x 505mm deep (not including gallows height).
The Harcombe is a light weight canopy, with a simple but effective style.

Drawing Title	Drawing No.	GW 08
HARCOMBE	Scale	Date
	1:20 @ A4	Sept '11